

Flymo

E47-2 9635431
9635432

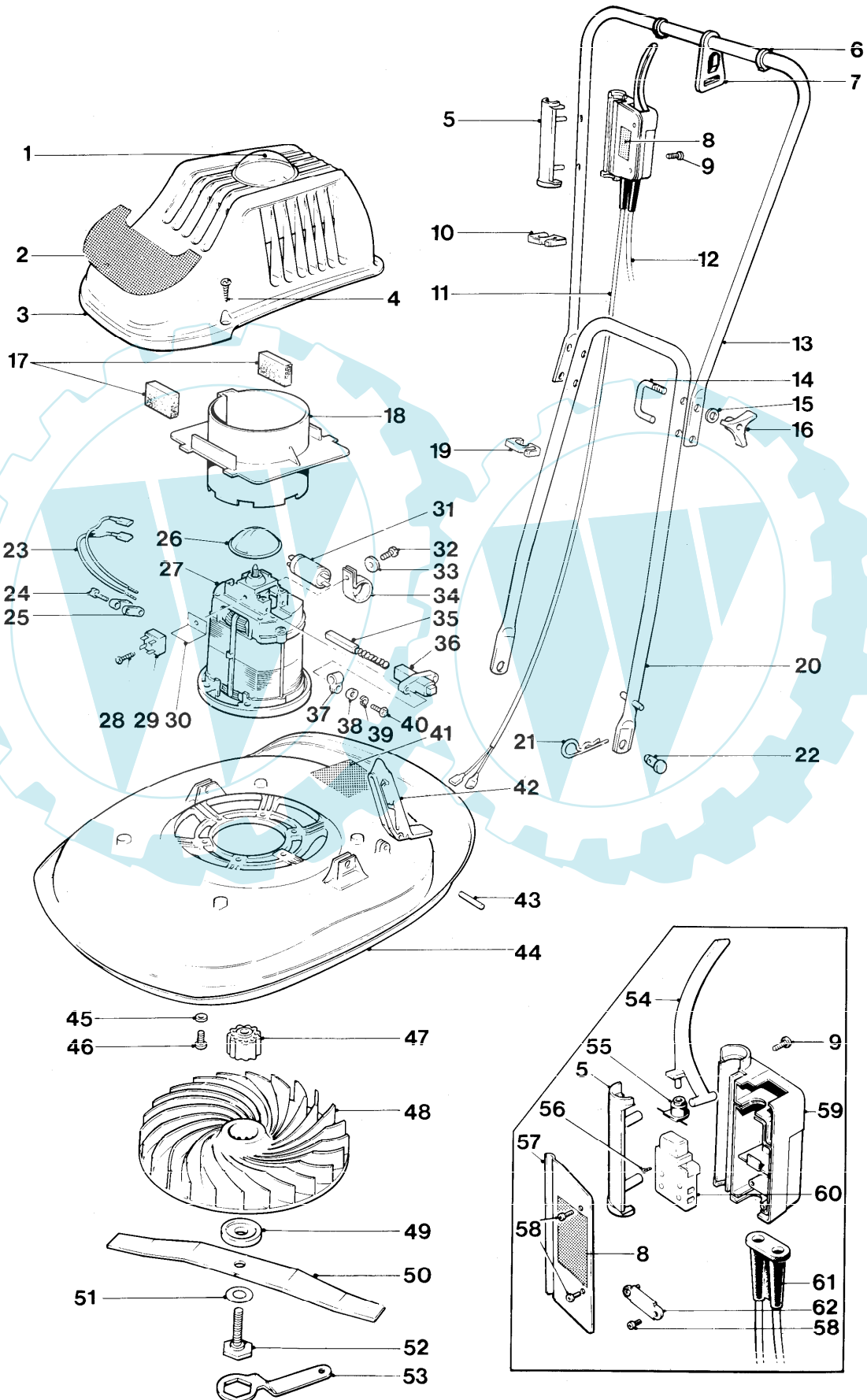

E47-2 9635431
9635432

KEY No.	PART No.	DESCRIPTION	QUANTITY	COMMENTS/ APPLICATION	KEY No.	PART No.	DESCRIPTION	QUANTITY	COMMENTS/ APPLICATION
1	5126120-02/0	LENS	1		33	322827-00/7	WASHER SPRING (PLATED)	1	
2	5126645-02/6	LABEL FLYMO	1		34	323017-00/4	CLIP	1	
3	5126375-10/3	COWL ASSY C/W LENS	1		35	322824-00/4	CARBON BRUSH	2	
3A	5116791-00/4	NOISE ABSORBTION JACKET	1	F.B.NL.D.SF.A.N.DK.I. (NOT ILLUSTR)	36	322819-00/4	BRUSH HOUSING	2	
4	5146824-00/7	SCREW	4	ALT USE 5147665-00/4	37	291890-00/2	CABLE CLAMP	1	
5	5126378-01/6	SWITCHBOX RETAINER 18mm	1		38	29100-00/5	WASHER	4	
6	5147793-00/3	CORD GUIDE CLIPS	2	D.	39	322827-00/7	WASHER SPRING (PLATED)	4	
7	5126240-00/0	RUNNER CABLE	1	D.AUST.	40	321689-00/2	SCREW M4 x 16 PH PHD	4	
8	5141611-00/3	LABEL CUT OUT	1	O/S.E.P.EI.	41	5146467-00/5	LABEL WARNING ELECTRIC	1	GB.O/S.E.P.EI.
	5141611-04/5	LABEL CUT OUT	1	DK.N.F.B.NL.		5136708-01/2	LABEL WARNING ELECTRIC	1	F.B.NL.CH.
	5141611-05/2	LABEL CUT OUT	1	F.B.NL.CH.		5136709-01/0	LABEL WARNING ELECTRIC	1	D.SF.S.
	5147822-01/8	LABEL CUT OUT	1	D.		5136712-01/4	LABEL WARNING ELECTRIC	1	I.D.K.N.
	5141611-02/9	LABEL CUT OUT	1	N.DK.		5146504-00/5	LABEL WARNING ELECTRIC	1	S.
	5141611-07/8	LABEL CUT OUT	1	I.		5147227-00/2	LABEL WARNING (ELCB)	1	S.
	5141611-09/4	LABEL CUT OUT	1	S.SF.	42	5116388-01/7	LEVER UP STOP	1	ALT USE 5116388-04/1
	5141611-01/1	LABEL CUT OUT	1	A.CH.	43	5147029-01/0	ROLL PIN	1	
	5141611-06/0	LABEL CUT OUT	1	O/S.	44	5106206-06/2	HOOD 47cm LESS UPSTOP	1	ALT USE 5147924-10/3
9	5146672-00/0	SCREW GKN POLYMATE	2			5147924-10/3	HOOD 47cm C/W UPSTOP	1	
10	5140482-00/0	CABLE CLIP SMALL	1		45	5146309-00/9	WASHER	6	
11	5147001-06/8	LEAD INTERNAL	1	GB.A.N.DK.F.B.NL.I.D.S.O/S. E. P.EI.	46	5141585-01/7	SCREW ¼-20UNC x 25LG	6	
	5147001-13/4	LEAD INTERNAL	1	CH.	47	5126133-00/7	PINION IMPELLER	1	
12	5147001-07/6	LEAD TERMINAL 15.24M x 1mm	1	GB.O/S.E.P.	48	5116197-01/2	IMPELLER	1	
	5147000-02/9	LEAD TERMINAL	1	A.N.DK.F.B.NL.I.S.	49	5136240-01/6	BLADE SPACER	3	
	5147213-00/2	LEAD TERMINAL C/W ELCB	1	S.	50	5126434-03/3	BLADE 47CM	1	
	5147000-04/5	LEAD TERMINAL	1	CH.SF.	51	5140516-00/5	ANTI FRICTION WASHER (PTFE)	1	
13	5126522-00/1	HANDLE UPPER PLASTIC COATED	1		52	5136242-01/2	BLADE BOLT	1	
	5126698-00/9	HANDLE UPPER PLASTIC COATED	1	LATER PRODUCED PRODUCTS	53	5130127-00/3	SPANNER	1	
	5126698-01/7	HANDLE UPPER PLASTIC COATED	1	D.	54	5136182-01/0	LEVER SWITCH	1	
14	5147542-00/4	J BOLT	2		55	5130406-01/9	SEAL CONE	1	
	5140607-00/2	BOLT HANDLE ¼ UNC x 45LG	2	LATER PRODUCED PRODUCTS	56	5141605-00/5	SCREW	4	
15	5140266-00/7	WASHER	2		57	5116495-00/2	SWITCHBOX COVER	1	
16	5140690-00/8	KNOB WING	2		58	5146672-00/0	SCREW GKN POLYMATE	4	
17	5146628-00/2	FILTER	2			5147212-01/2	SCREW NO6X16LG TAMPER PROOF	2	S.
18	5116423-00/4	SUPPORT FILTER	1		59	5116641-01/9	SWITCHBOX BODY	1	
19	5140863-01/9	CABLE CLIP LARGE	1		60	5141586-14/8	SWITCH ON OFF THERMAL CUT OUT	1	KOPP 2401-18
20	5126696-00/3	HANDLE LOWER	1		61	5141584-01/0	SLEEVE PROTECTION	1	
	5126696-01/1	HANDLE LOWER	1	LATER PRODUCED PRODUCTS	62	5146616-00/7	CLAMP CABLE	1	
21	5140423-00/4	PIN RETAINING	2						
22	5140092-01/5	PIN LOCKING	2	ALT USE 5140092-00/7					
23	322839-01/0	LEAD	2						
24	5146672-00/0	SCREW GKN POLYMATE	2						
25	5140705-00/4	CABLE CLAMP	2						
26	5136241-00/6	DISC WARNING ASSY	1						
27	5148040-00/8	MOTOR 240 VOLT	1	GB					
	5148040-01/6	MOTOR 220 VOLT	1						
	5148031-01/5	MOTOR 220 VOLT	1	CH					
28	7241293-61/7	SCREW THREAD FORMING	1						
29	322814-00/5	RECTIFIER	1						
30	322812-02/5	INSULATOR	1						
31	323116-00/4	SUPPRESSOR & CLIP	1						
32	341624-01/3	SCREW M4X8 PH RND	1						

* FOR PRODUCT 9635432-73 KEY NOS 11, 12, 54—62 ARE NOT APPLICABLE
USE COMPLETE SWITCHBOX 5126500-02/3

PRODUCT VARIANT

9635431-25 GB
9635432-72 F.B.NL.

9635432-73 D.SF.A.
9635432-74 N.DK.I.

9635432-75 S.
9635432-76 CH.

9635432-77 O/S.E.P.EI.

Ihr Ersatzteilspezialist im Internet